



GAST MANUFACTURING, INC.
A Unit of IDEX Corporation
Post Office Box 97
Benton Harbor, Michigan
Ph: 269/926-6171
Fax: 269/925-8288

PART NUMBER:

LTD177

REV.

F

Product Specifications

MODEL NUMBER	MOTOR SPECIFICATIONS	RPM	MAX VAC		MAX PRESS		NET WT.	
			"H ₂ O mbar	"H ₂ O mbar	HP	kW	lbs.	kg
R4310P-50	208-230/460-60-3	3450	48	120	51	127	1.0	0.75
	220/380-50-3	2850	35	87	38	95	0.6	0.45

SOUND LEVEL 68/64 dB(A) MAX, @ 60/50 Hz
 NORMAL AMBIENT -29°C TO 40°C
 RELATIVE HUMIDITY 0% - 100% NON CONDENSING
 ENVIRONMENT CLEAN DUST FREE

UL AND CSA APPROVED MOTOR FOR EXPLOSIVE GAS ATMOSPHERES CLASS 1, GROUP D, CLASS 2, GROUP F AND G.

THIS BLOWER IS DESIGNED FOR SOIL AND GROUND WATER REMEDIATION.

TECHNICAL DATA SUBJECT TO CHANGE WITHOUT NOTICE.

Product Performance

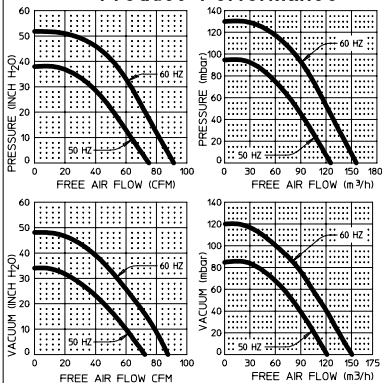

PERFORMANCE DATA
 THE PERFORMANCE DATA SHOWN WAS DETERMINED UNDER THE FOLLOWING CONDITIONS:

LINE VOLTAGE @ 60 Hz, 230V OR 460V FOR 3 PHASE UNITS, 115V OR 230V FOR 1 PHASE UNITS.

LINE VOLTAGE @ 50 Hz, 220V FOR 3 PHASE OR 1 PHASE UNITS.

UNITS IN A TEMPERATURE STABLE CONDITION.

DELIVERY MEASUREMENTS MADE WITH OUTPUT PORT THROTTLED.

SUCTION MEASUREMENTS MADE WITH INPUT PORT THROTTLED.

TEST CONDITIONS: INLET AIR DENSITY @ 0.075 lbs. per cu. ft. (20°C (68°F), 29.92" Hg (14.7 PSIA)).

NORMAL PERFORMANCE VARIATIONS ON THE RESISTANCE CURVE WITHIN +10% OF SUPPLIED DATA CAN BE EXPECTED.

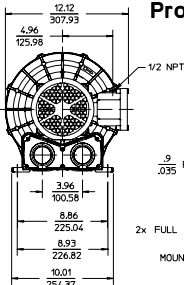
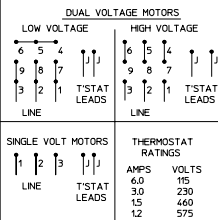

Product Dimensions mm/inches

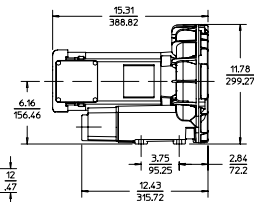

USE A MANUAL MOMENTARY START SWITCH ONLY

MOUNTING HOLE DETAIL (4)