

HSK-A shell milling arbors

Product information

- to hold shell mills DIN 841, arbor-type single angle cutters DIN 842 with keyway, shell mills DIN 1880 with keyway an milling cutters with inserts DIN 1830
- bore-Ø 40 and 50 mm has four additional holes with internal thread for milling heads with tool attachment DIN 2079

Scope of delivery

- completely assembled with milling cutter retaining screw, Guhring no. 4908, drive dogs, Guhring no. 4922 and feather key Guhring no. 4923

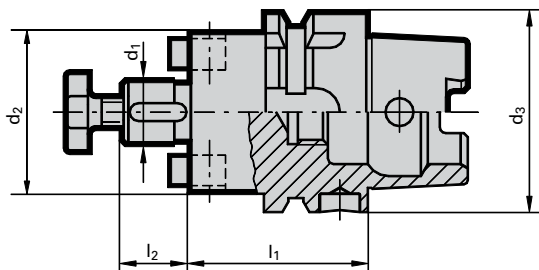

Series Number **4361**

HSK-A d ₃	arbor-Ø d ₁ mm	d ₂ mm	l ₁ mm	l ₂ mm	kg	Order Code	EDP Numbers
32	16	40	45	17	0.27	16.032	9043610160320
32	22	50	50	19	0.4	22.032	9043610220320
40	16	40	45	17	0.4	16.040	9043610160400
40	22	50	50	19	0.5	22.040	9043610220400
50	16	40	45	17	0.6	16.050	9043610160500
50	22	50	50	19	0.8	22.050	9043610220500
50	27	60	55	21	1	27.050	9043610270500
63	16	40	45	17	0.9	16.063	9043610160630
63	22	50	50	19	1	22.063	9043610220630
63	27	60	55	21	1.3	27.063	9043610270630
63	32	78	55	24	1.6	32.063	9043610320630
63	40	89	60	27	2.1	40.063	9043610400630
80	16	40	45	17	2.1	16.080	9043610160800
80	22	50	50	19	2.3	22.080	9043610220800
80	27	60	55	21	2.5	27.080	9043610270800
80	32	78	55	24	2.6	32.080	9043610320800
80	40	89	60	27	3.4	40.080	9043610400800
100	22	50	50	19	2.5	22.100	9043610221000
100	27	60	55	21	2.8	27.100	9043610271000
100	32	78	55	24	3.1	32.100	9043610321000
100	40	89	60	27	3.7	40.100	9043610401000
100	50	120	70	30	5.6	50.100	9043610501000

Positioning of accessories

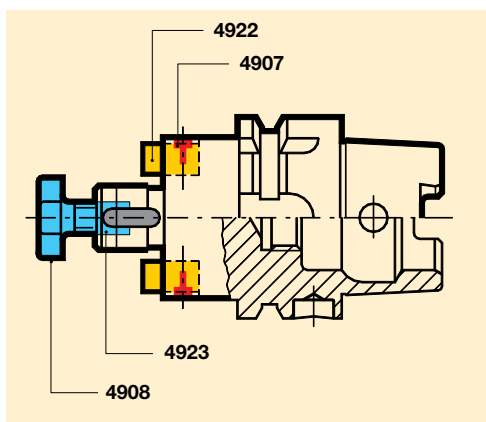

Feather keys DIN 6885 A

Scope of delivery

- minimum order quantity 10



Series Number **4923**

for arbor-Ø mm	l ₁ mm	b mm	EDP Numbers
16	14	4	9049230040160
22	16	6	9049230060220
27	19	7	9049230070270
32	22	8	9049230080320
40	25	10	9049230100400
50	28	12	9049230120500